

# Parting Off Tools

## GENERAL HINTS ON PARTING OFF TOOLS

Dormer's parting off tools are indexable-type inserts with three edges. Manufactured in cobalt alloyed high speed steel, they are available in bright, TiN coated or TiAlN coated. TiAlN is harder than TiN and can withstand higher temperatures.

The sides of the inserts are hollow ground, which means that the clearance will be correct radially as well as axially.

A chip breaker has been shaped in the cutting surface of the edge in order to obtain the best possible type of chips when working in long-chipping materials.

## INDEXABLE INSERTS IN TWO SIZES

Indexable inserts are available in two sizes with straight edges and with 8° and 15° lead angle in both left hand and right hand versions.

Inserts for standard retaining ring size grooves, with widths of 1.1, 1.3, 1.6, 1.85 and 2.15 mm, are also available.

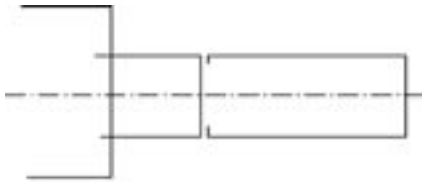
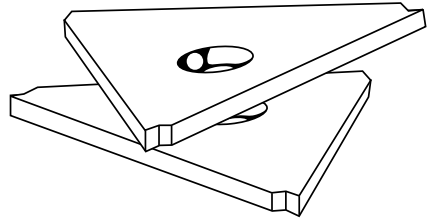

lead angle

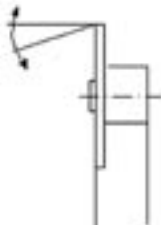

straight



right hand holder

right hand



left hand



left hand holder

